



The new degree of comfort.®

# Rheem® Hybrid Utility Residential Electric Water Heater

## Designed to Maximize Energy Design Rating / HERS Rating

### Product Highlights

- 3.50 UEF
- Meets NEEA Tier 3 Requirements
- Integrated WiFi
- California Title 24 Compliant (JA13 Ready)
- Grid-Enabled for Utility-Level Performance Monitoring
- Quiet Operation
- Design certified to NSF/ANSI 372 (lead control)
- CTA 2045 Ready (adapter included)
- 10 Year Limited Warranty<sup>1</sup>



| FEATURES & BENEFITS                       |  |
|---|--|
| <b>High Efficiency</b>                    | Meets ENERGY STAR® requirements  |
|   | Increased property value for consumers   |
| <b>Easy Installation</b>                  | Easily Ducted – for installation in confined spaces with minimal make up air required  |
|   | Easy access to side water connection and top electrical junction box; <i>Zero clearance required in the back or side of the unit</i> |
|   | ¾" NPT water inlet & outlet; ¾" condensate drain connections   |
|   | Dry fire protection  |
| <b>Available EcoNet® Smart Technology</b> | Integrated WiFi <sup>2</sup>   |
|   | Energy usage reporting   |
|   | Grid interactive for utility demand response / load management programs  |

**Hybrid Electric Utility Select**  
40, 50, 65 and 80-Gallon Capacities  
208-240 Volt / 1 PH / 24 Amps



LEED Points = 3

| DESCRIPTION             |                       |                    |               |                       | ENERGY INFO.                |                              | FEATURES         |                             |                               |                 |                         |
|-------------------------|-----------------------|--------------------|---------------|-----------------------|-----------------------------|------------------------------|------------------|-----------------------------|-------------------------------|-----------------|-------------------------|
| NOMINAL GALLON CAPACITY | RATED GALLON CAPACITY | MODEL NUMBER       | MODEL VARIANT | ELECTRIC BREAKER SIZE | UNIFORM ENERGY FACTOR (UEF) | ESTIMATED YEARLY ENERGY COST | COMPRESSOR BTU/H | UEF FIRST HR. RATING G.P.H. | RECOVERY IN G.P.H. 90° F RISE | UNIT WT. (LBS.) | APPROX. SHIP WT. (LBS.) |
| 40                      | 36                    | PRO H40 T2 RH310UM | 701440        | 30                    | 3.50                        | \$111                        | 4200             | 60                          | 26                            | 156             | 177                     |
| 50                      | 45                    | PRO H50 T2 RH310UM | 701439        | 30                    | 3.50                        | \$111                        | 4200             | 67                          | 26                            | 172             | 193                     |
| 65                      | 59                    | PRO H65 T2 RH310UM | 701441        | 30                    | 3.50                        | \$111                        | 4200             | 75                          | 26                            | 225             | 262                     |
| 80                      | 72                    | PRO H80 T2 RH310UM | 701442        | 30                    | 3.50                        | \$170                        | 4200             | 87                          | 26                            | 244             | 281                     |

Estimated energy cost based on a national average electricity cost of 12.00 /kWh. Uniform Energy Factor and rated gallon capacity based on Department of Energy (DOE) requirements. Units meet or exceed ANSI requirements and have been tested according to D.O.E. procedures. Units meet or exceed the energy efficiency requirements of NAECA, ASHRAE standard 90, ICC Code and all state energy efficiency performance criteria.  
<sup>1</sup> See Residential Warranty Certificate for complete information. <sup>2</sup> WiFi broadband internet connection required. <sup>3</sup> Consult your tax advisor for details on eligibility requirements for any available tax credits. Rebates vary by state.

For more product information, visit: [Rheem.com/Hybrid](http://Rheem.com/Hybrid)



# Rheem® Hybrid Utility Residential Electric Water Heater

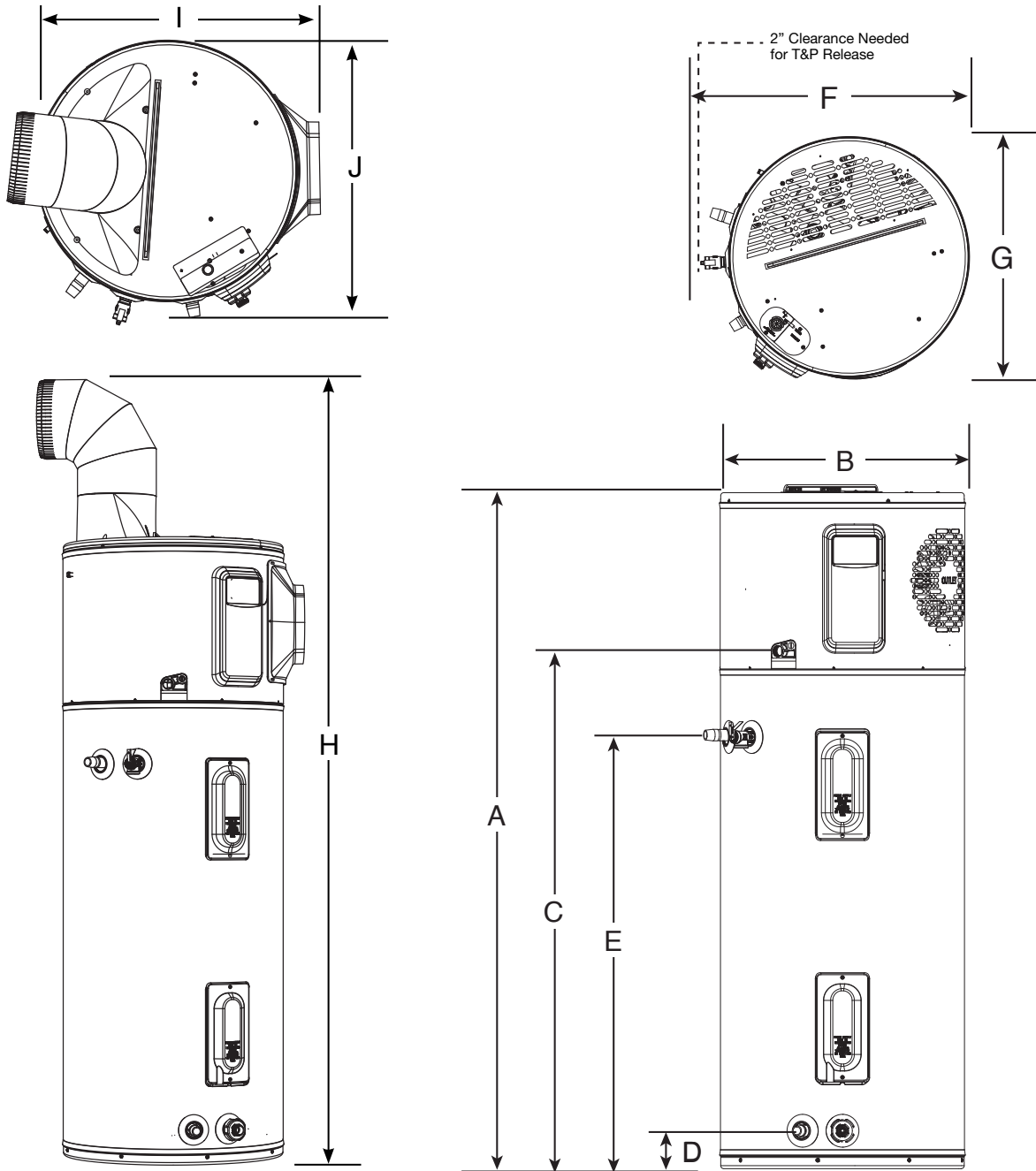

| DESCRIPTION             |                    | DIMENSIONS (SHOWN IN INCHES) |        |    |       |        |    |    |        |        |         |
|-------------------------|--------------------|------------------------------|--------|----|-------|--------|----|----|--------|--------|---------|
| NOMINAL GALLON CAPACITY | MODEL NUMBER       | A                            | B      | C  | D     | E      | F  | G  | H      | I      | J       |
| 40                      | PRO H40 T2 RH310UM | 63                           | 20-1/4 | 47 | 3-5/8 | 39-5/8 | 28 | 24 | 78-7/8 | 22-3/8 | 23-1/4  |
| 50                      | PRO H50 T2 RH310UM | 61                           | 22-1/4 | 47 | 3-5/8 | 39-5/8 | 28 | 24 | 78-5/8 | 24-3/8 | 25-9/16 |
| 65                      | PRO H65 T2 RH310UM | 64                           | 24-1/4 | 49 | 3-7/8 | 42-3/8 | 30 | 26 | 81-1/8 | 26-1/2 | 27-3/8  |
| 80                      | PRO H80 T2 RH310UM | 74                           | 24-1/4 | 59 | 3-7/8 | 52-3/8 | 30 | 26 | 91     | 26-1/2 | 27-3/8  |

# Rheem® Hybrid Utility Residential Electric Water Heater

## Heater: Not Ducted

Room size: Larger than 700 ft<sup>3</sup> (e.g. 7' x 10' x 10').  
 Requirements: No additional ventilation needed.

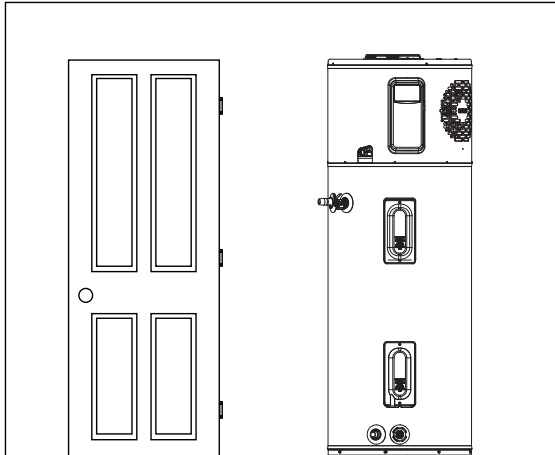

## Heater: Not Ducted

Room size: Smaller than 700 ft<sup>3</sup> (e.g. 7' x 10' x 10').  
 Requirements: Full louvered door OR two louvers top and bottom. See below.

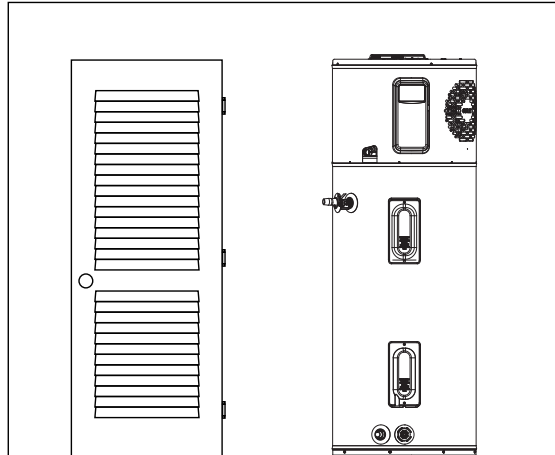

## Heater: Not ducted

Room: Small Closet

Requirements: \* Air gap under door equal to 18 in<sup>2</sup> (0.75" clearance).

\* Louver must be located the same height on door as the air exhaust on heater.

\* Heater air exhaust must be positioned towards louver within one foot of door.

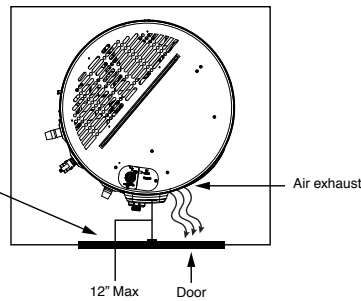
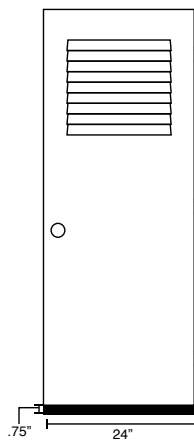

## Heater: Ducted with inlet OR outlet duct

Room size: Any size room

Requirements: Air gap under door equal to 18 in<sup>2</sup> (0.75" clearance)

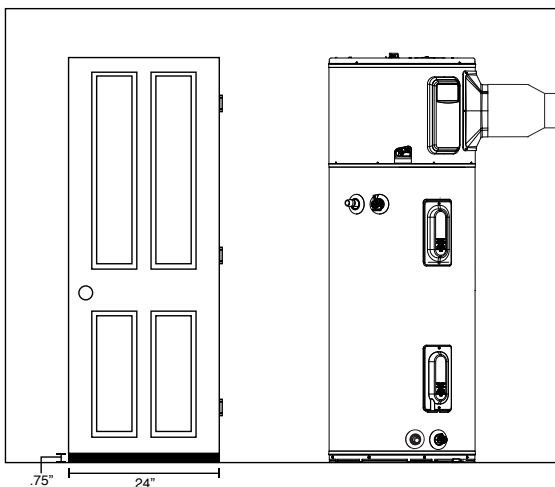

## Heater: Ducted with inlet AND outlet duct

Room size: Any size room

Requirements: No additional ventilation needed.

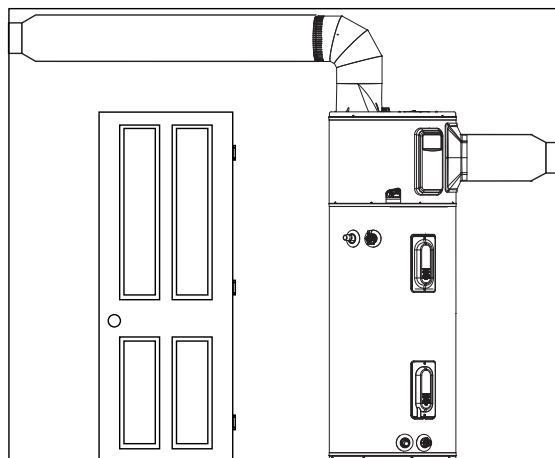



The new degree of comfort®



Residential Electric  
Hybrid Utility  
Water Heaters

## Hybrid Utility Accessories

| PART NUMBER | DESCRIPTION                              | USE FOR   |
|-------------|--|---|
| SP20882     | Earthquake Isolation Kit                 | Installations in seismic regions                                  |
| SP20883     | Vibration Isolation Kit                  | Installation on non-concrete floors                               |
| SP20884     | 8" Diameter UL Certified Termination Kit | Termination to the outside or to the attic with 8" diameter       |
| SP20885     | 7" Diameter UL Certified Termination Kit | Termination to the outside or to the attic with 7" diameter       |
| SP20886     | 6" Diameter UL Certified Termination Kit | Termination to the outside or to the attic with 6" diameter       |
| SP20887     | 5" Diameter UL Certified Termination Kit | Termination to the outside or to the attic with 5" diameter       |
| SP20888     | 8" Rheem Approved Damper Kit             | Exhaust only to the outside ducting configuration (no inlet duct) |
| SP20889     | 25' Flexible 8" Diameter Duct Kit        | For up to 25' of ducting  |
| SP20890     | Rigid Elbow Duct Kit                     | Installation in tight places where space needs to be minimized    |
| AP17829     | Outlet Duct Adapter                      | Allows for ducting to be connected to the unit                    |
| AP19134     | Leak Sensor                              | Automatic detection of internal and external leaks                |
| AP21365     | Inlet Duct Adapter                       | Allows for ducting to be connected on the top inlet               |



SP20882



SP20883

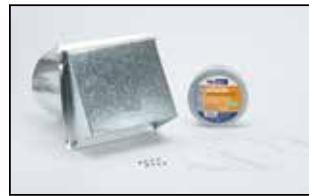

SP20884



SP20885



SP20886



SP20887



SP20888



SP20889



SP20890



AP17829

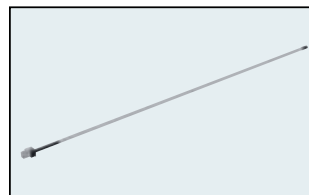

AP19134



AP21365

In keeping with its policy of continuous progress and product improvement, Rheem reserves the right to make changes without notice.

Rheem Water Heating • 1115 Northmeadow Parkway, Suite 100  
Roswell, Georgia 30076 • www.rheem.com

Rheem Canada Ltd./Ltée • 125 Edgeware Road, Unit 1  
Brampton, Ontario L6Y 0P5 • www.rheem.com



INTEGRATED HOME COMFORT